

## Office Space Near 23<sup>rd</sup> and Rockwell

**3040 Square Feet at 6800 NW 23rd, Bethany, OK**

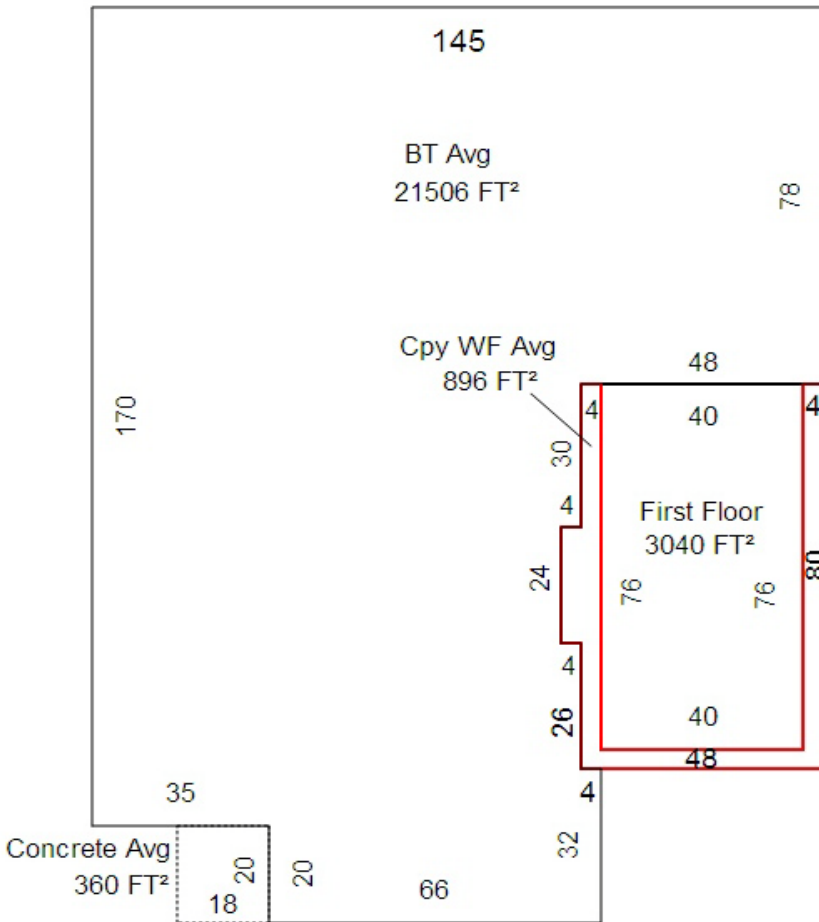

- **Former Retail Finance Store**
- **Substantial Parking (47 Spaces)**
- **Just East of 23<sup>rd</sup> and Rockwell**
- **2 Miles North of Interstate-40**
- **\$7.90 per foot (\$2,000/month)**

**Near Wal-Mart Grocery, Firestone,  
McDonalds and Pizza Hut.**

**Herndon & Kelley Commercial Real Estate:  
Todd Herndon, CCIM (405) 848-8099**

This document is an informational summary for review by prospective investors/principals and or their advisors to determine their interest in the subject property. Although the information contained herein has been prepared by Herndon and Kelley Commercial Real Estate or has been furnished by sources deemed reliable, none of such information has been verified and no representation, either expressed or implied is made as to the accuracy thereof. All information contained herein is further subject to correction, modification or withdrawal without further notice. This information is confidential in nature, and should not be reproduced in whole or in part without the express consent of the listing broker.